



Distributed by:  **MIFAB**®

ACV

(AUTOMATIC CONTROL VALVES)



LIT-202



MANUAL CONTROL VALVE
(M) (page 8)



SOLENOID CONTROLLED
VALVE (EL) (page 8)



PRESSURE REDUCING
VALVE (PR) (page 9)



SOLENOID CONTROLLED
PRESSURE REDUCING
VALVE (PREL) (page 9)



PRESSURE SUSTAINING
VALVE (PS) (page 10)



DIFFERENTIAL PRESSURE
SUSTAINING VALVE (DIF)
(page 10)



PRESSURE REDUCING AND
SUSTAINING VALVE (PRPS)
(page 11)



FLOAT LEVEL CONTROL
VALVE (FL) (page 11)



ELECTRIC FLOAT LEVEL
CONTROL VALVE (FLEL)
(page 12)



DIFFERENTIAL FLOAT
LEVEL CONTROL VALVE
(DIFL) (page 12)



QUICK PRESSURE RELIEF
VALVE (QR) (page 13)



FLOW RATE CONTROL
VALVE (FR) (page 13)



PUMP (BOOSTER)
CONTROL VALVE (PC)
(page 14)



SURGE ANTICIPATING
VALVE (SA) (page 14)



PUMP (DEEP WELL)
CONTROL VALVE (DPC)
(page 15)



EXCESSIVE FLOW SHUT-
OFF VALVE (FE) (page 15)



ALTITUDE CONTROL VALVE
(ALT) (page 16)



ELECTRONICALLY
CONTROLLED VALVE (EC)
(page 16)



BI-LEVEL ALTITUDE
CONTROL VALVE (ALT-B)
(page 17)



FLOW RATE CONTROL AND
PRESSURE REDUCING
VALVE (FRPR) (page 17)

CALIFORNIA PROPOSITION 65 WARNING. This product contains chemicals known to the State of California to cause cancer and birth defects or other reproductive harm.

Contents

HYDRAULIC CONTROL VALVES	4
MANUAL CONTROL VALVE (M)	8
SOLENOID CONTROLLED VALVE (EL)	8
PRESSURE REDUCING VALVE (PR)	9
SOLENOID CONTROLLED PRESSURE REDUCING VALVE (PREL)	9
PRESSURE SUSTAINING VALVE (PS)	10
DIFFERENTIAL PRESSURE SUSTAINING VALVE (DIF)	10
PRESSURE REDUCING AND SUSTAINING VALVE (PRPS)	11
FLOAT LEVEL CONTROL VALVE (FL)	11
ELECTRIC FLOAT LEVEL CONTROL VALVE (FLEL)	12
DIFFERENTIAL FLOAT LEVEL CONTROL VALVE (DIFL)	12
QUICK PRESSURE RELIEF VALVE (QR)	13
FLOW RATE CONTROL VALVE (FR)	13
PUMP (BOOSTER) CONTROL VALVE (PC)	14
SURGE ANTICIPATING VALVE (SA)	14
PUMP (DEEP WELL) CONTROL VALVE (DPC)	15
EXCESSIVE FLOW SHUT-OFF VALVE (FE)	15
ALTITUDE CONTROL VALVE (ALT)	16
ELECTRONICALLY CONTROLLED VALVE (EC)	16
BI-LEVEL ALTITUDE CONTROL VALVE (ALT-B)	17
FLOW RATE CONTROL AND PRESSURE REDUCING VALVE (FRPR)	17

CALIFORNIA PROPOSITION 65 WARNING: This product contains chemicals known to the State of California to cause cancer and birth defects or other reproductive harm.



HYDRAULIC CONTROL VALVES

BEECO® ACV Series Basic Valve is a hydraulically operated diaphragm actuated, globe pattern valve. It consists of three major components; body, diaphragm assembly and cover. With any effect of the pressure to the diaphragm, the diaphragm moves up/down. With pressure build up in the actuator chamber, the valve is closed with full tightness. When pressure reduces in the actuator chamber or there is low pressure than the inlet pressure in the actuator chamber, the valve allows water to pass. BEECO® ACV series control valves are used for many applications such as pressure regulation, flow control and level control. As with all BEECO® products it offers low cost of ownership due to the ease of repair and maintenance.

PRINCIPLES OF OPERATION

OPENING MODE

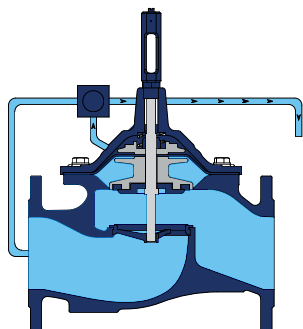

When pressure in the cover chamber is relieved to a zone of lower pressure, the line pressure at the valve inlet opens the valve, allowing full flow.

CLOSING MODE

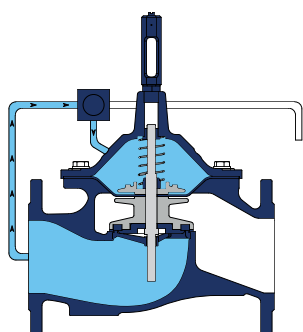

When pressure from the valve inlet is applied to the cover chamber, the valve closes drip-tight.

MODULATION MODE

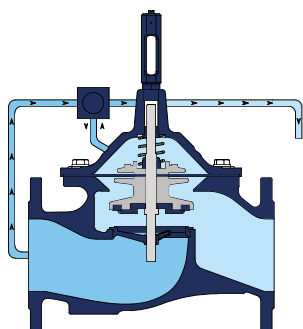

The valve holds any intermediate position when operating pressures are equal above and below the diaphragm.

CALIFORNIA PROPOSITION 65 WARNING. This product contains chemicals known to the State of California to cause cancer and birth defects or other reproductive harm.

MAIN PARTS		
No.	PART NAME	MATERIAL
1	Body	GGG50 (Ductile Iron)
2	Bonnet	GGG50 (Ductile Iron)
3	Seat	AISI304 Stainless Steel
4	Disc	GGG50 (Ductile Iron)
5	Rubber Seal	Natural Rubber, EPDM (Optional)
6	Disc Washer	AISI304 Stainless Steel
7	Diaphragm	Natural Rubber, EPDM (Optional)
8	Diaphragm Disc	GGG50 (Ductile Iron)
9	Spring	AISI302 Stainless Steel
10	Stem	AISI304 Stainless Steel
11	Stem Bearing	AISI304 Stainless Steel
12	O-Ring	NBR
13	Fiber Nut	AISI304 Stainless Steel
14	Plug	Brass
15	Bolts & Nuts	Galvanized, AISI304, Stainless Steel (Optional)
16	Washer	Galvanized, AISI304, Stainless Steel (Optional)

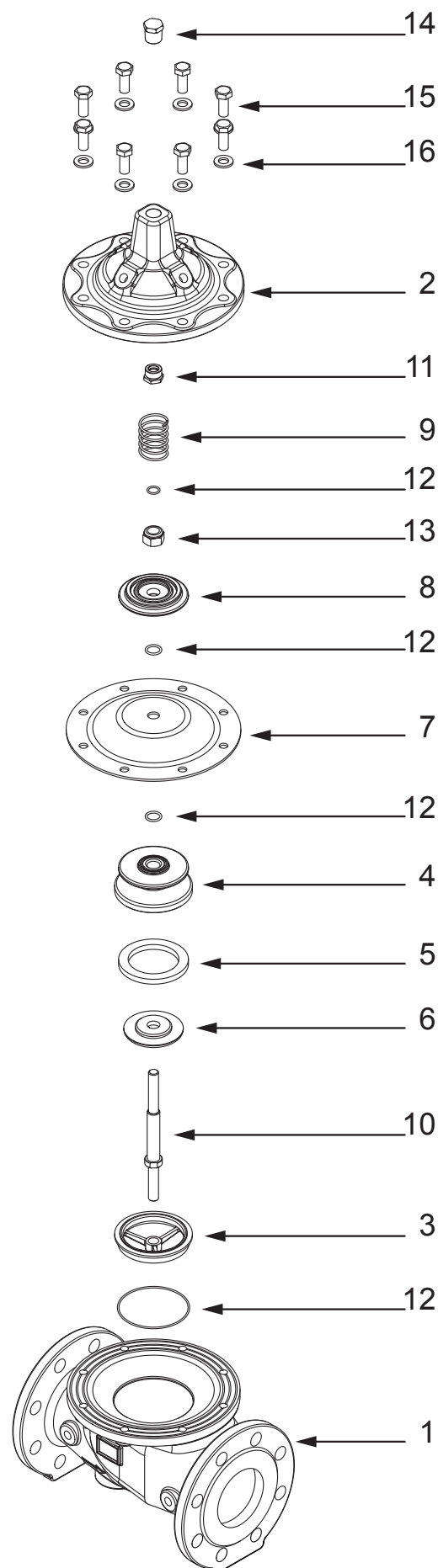

CALIFORNIA PROPOSITION 65 WARNING: This product contains chemicals known to the State of California to cause cancer and birth defects or other reproductive harm.

TECHNICAL SPECIFICATIONS

PRESSURE RATING	Standard	0.5 - 16 bar (7.5 - 240 psi)
	High Pressure Range	0.5 - 25 bar (7.5 - 360 psi)
TEMPERATURE	Min. Operating Temperature	- 50 °F (10 °C) DIN 2401 / 2
	Max. Operating Temperature	176 °F (80 °C) DIN 2401 / 2
CONNECTION	Flanged	Standard: EN 1092/2, Optional: ANSI, BS 10-E
COATING	Standard	Epoxy
	Optional	Polyester
HYDRAULIC CONNECTIONS	Standard	Copper
	Optional	SST, Reinforced Nylon Hydraulic Pipe · SAEJ 844
ACTUATOR TYPE	77 Model	Single Chamber, Diaphragm Actuated, Disc Closed Type
DESIGN	EN 1074-5	

AVAILABLE MODEL

ACV 77

Connection	Flanged
Material	Ductile Iron (GGG50)
Body Pattern	Globe
Operating Pressure	16 bar (240 psi) - 25 bar (360 psi)
Available Sizes	2" (50)
	2 1/2" (65)
	3" (80)
	4" (100)
	6" (150)
	8" (200)

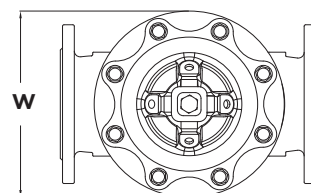
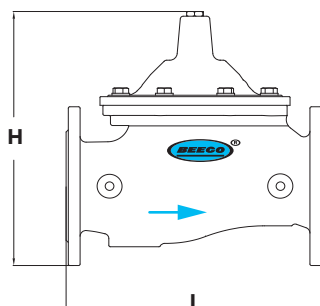

DN	H	L	W	WEIGHT	
2" (50)	10,2" (260)	9,1" (230)	6,9" (170)	29,7 lbs.	13,5 kg
2 1/2" (65)	10,6" (270)	11,4" (290)	6,9" (170)	35,2 lbs.	16 kg
3" (80)	12,4" (315)	12,2" (310)	9" (228)	52,8 lbs.	24 kg
4" (100)	13,8" (350)	13,8" (350)	10,2" (258)	70,4 lbs.	32 kg
6" (150)	21,5" (545)	18,9" (480)	15,4" (392)	189,2 lbs.	86 kg
8" (200)	24,6" (625)	23,6" (600)	18,2" (462)	330 lbs.	150 kg

CALIFORNIA PROPOSITION 65 WARNING. This product contains chemicals known to the State of California to cause cancer and birth defects or other reproductive harm.

HYDRAULIC PERFORMANCE

Valve Size		2" (50)	2 1/2" (65)	3" (80)	4" (100)	6" (150)	8" (200)
Kv	m ³ /h @ 1 bar	50	75	115	200	380	700
Cv	gpm @ 1 psi	58	87	133	231	439	809
Max. Flow Continuance	m ³ /h	39	66	100	156	350	622
	gpm	171	289	438	685	1541	2739
Max. Flow Intermittent	m ³ /h	78	131	199	311	573	848
	gpm	342	579	876	1369	2521	3735

$$K_v, C_v = Q \sqrt{\frac{G}{\Delta P}} \quad C_v = 1,155 K_v$$

Kv : Valve flow coefficient
(flow in m³/h at 1 bar differential pressure)

Cv : Valve flow coefficient
(flow in gpm at 1 psi differential pressure)

Q : Flow rate (m³/h ; gpm)

ΔP : Differential pressure (bar ; psi)

G : Liquid specific gravity (Water = 1.0)

HEAD LOSS CHART

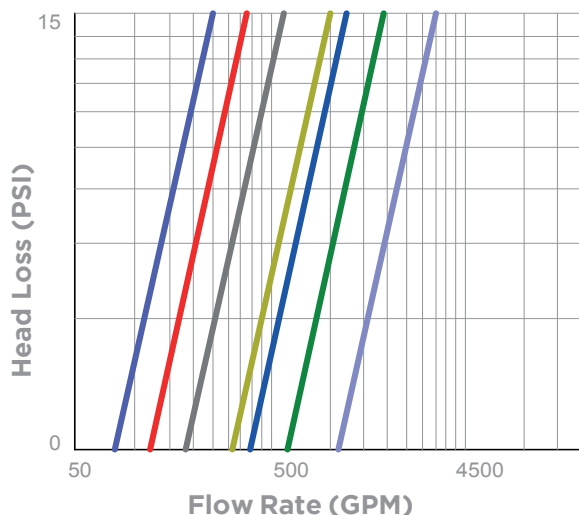

- 2" (50)
- 2.5" (65)
- 3" (80)
- 4" (100)
- 6" (150)
- 8" (200)

CAVITATION CHART

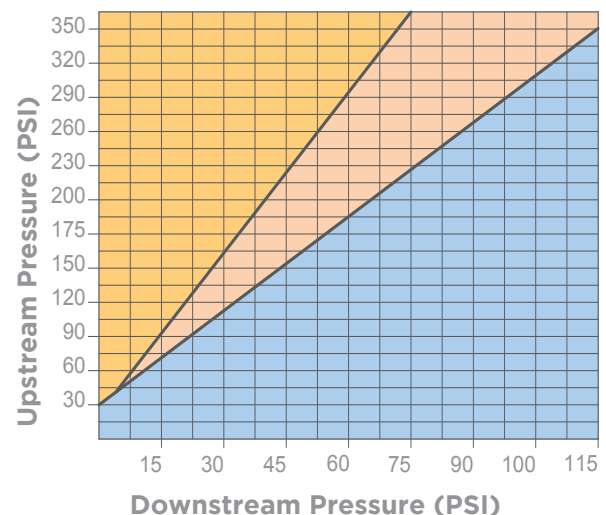

For the purpose of using cavitation charts:

- Determine the valve upstream pressure specified in the system on the charts.
- Make the required downstream pressure intersect the determined downstream pressure.
- Determine the cavitation condition of the valve based on 3 areas whose intersections are shown on the charts.

- CAVITATION ZONE
- NOISY OPERATION ZONE
- SAFETY ZONE

CALIFORNIA PROPOSITION 65 WARNING. This product contains chemicals known to the State of California to cause cancer and birth defects or other reproductive harm.



MANUAL CONTROL VALVE (M)

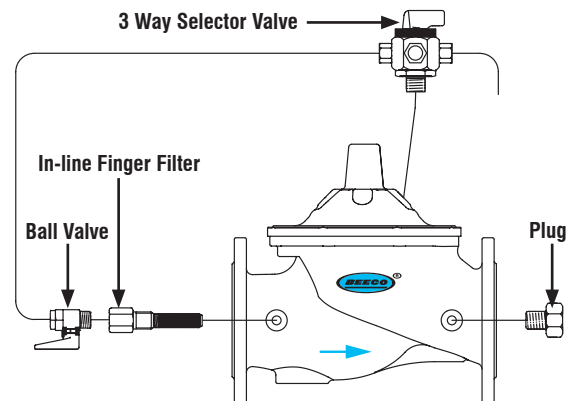

BEECO® "M" model manual control valves are hydraulic control valves that operate with line pressure and provide on-off with a 3-way selector valve. The minimum operating pressure of the valve is 0.5 bar. Thanks to its flexible diaphragm, rigidly seated valve stem and stainless steel spring, it provides easy and fast control in high pressure applications and it closes completely tightened. It can be used in many different applications by adding different pilot valves on the main valve body.



SOLENOID CONTROLLED VALVE (EL)

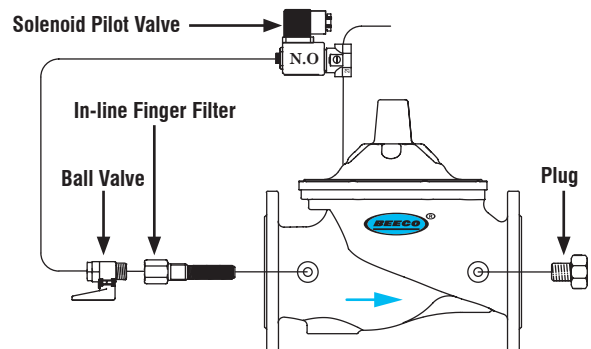

BEECO® "EL" model solenoid controlled valves are hydraulic control valves that perform the on-off operation by controlling the 3/2-way solenoid pilot valves mounted on valve with a remote electrical signal. The electrical signal to the solenoid pilot valves is provided by a control equipment such as control device, time relay, switch, PLC control units. Thanks to the manual control screw on the solenoid pilot valve, it can be easily opened and closed. 24 Volt AC 50Hz or 60 Hz, 12 Volt DC, 9 Volt DC latch and 12 Volt DC latch, normally open (N.O) or normally closed (N.C.) solenoid coils can be used on the main valve.

CALIFORNIA PROPOSITION 65 WARNING. This product contains chemicals known to the State of California to cause cancer and birth defects or other reproductive harm.

PRESSURE REDUCING VALVE (PR)

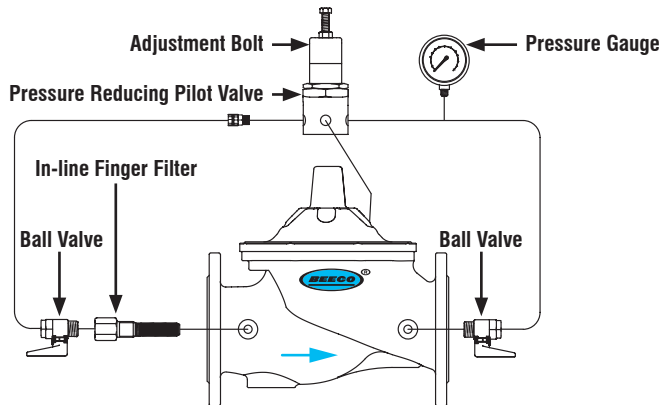

BEECO® “PR” model pressure reducing valves are hydraulic control valves that reduce the high inlet pressure value into a lower desired pressure value thanks to the pressure reducing pilot. The pressure reducing control valve constantly controls the desired output pressure value without being affected by the flow rate and inlet pressure values and keeps it constant. When there is no flow in the system, the valve automatically closes itself as drip-tight. When the valve inlet pressure value in the system falls below the set outlet pressure value, the valve opens fully. The valve can be used in horizontal or vertical positions in the system.

SOLENOID CONTROLLED PRESSURE REDUCING VALVE (PREL)

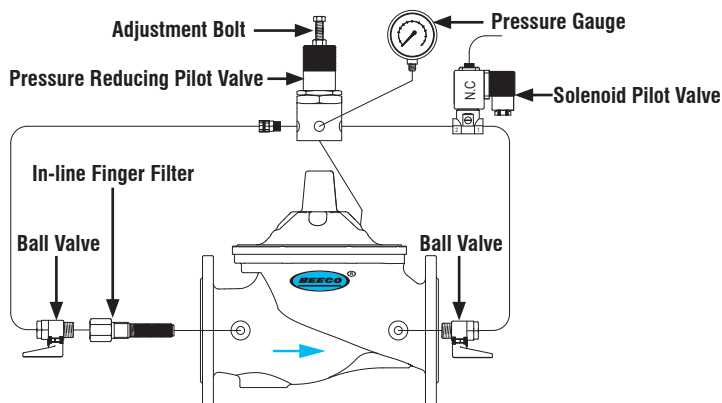

BEECO® “PREL” model solenoid controlled pressure reducing valves are hydraulic control valves that reduce the high inlet pressure value into a lower desired pressure value. The control of the main valve is realized by means of 3/2 way solenoid pilot valves. The electrical signal to the solenoid pilot valves is provided by a control equipment such as control device, time relay, switch, PLC control units. Thus, automation and control are easily provided in application systems.

CALIFORNIA PROPOSITION 65 WARNING. This product contains chemicals known to the State of California to cause cancer and birth defects or other reproductive harm.

PRESSURE SUSTAINING VALVE (PS)

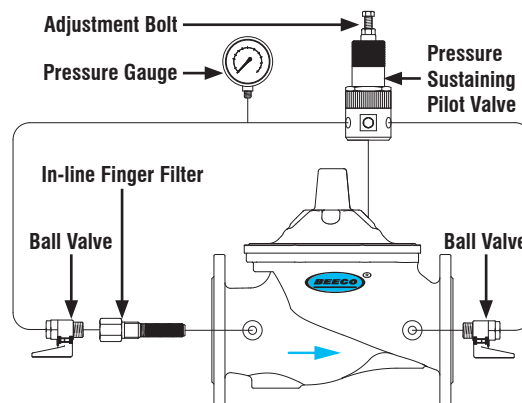

BEECO® “PS” model pressure sustaining valves are control valves that maintains valve inlet pressure value constant. The valve opens when the line pressure reaches the valve set pressure level. Thanks to this feature, it enables the pump motor to rise without load in pumping systems. Thus, it also prevents positive pressure waves caused by the pump, When it starts to operate. The valve keeps the inlet pressure value constant by controlling it, without being affected by the flow rate changes. When there is no flow, the valve closes itself completely sealed.



DIFFERENTIAL PRESSURE SUSTAINING VALVE (DIF)

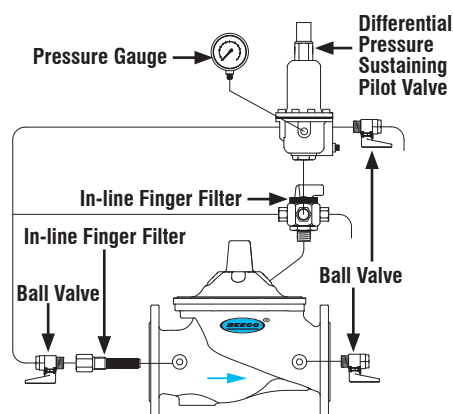

BEECO® “DIF” model differential pressure sustaining valves keep the differential pressure between two positions at a constant value without being affected by variable flow rate and inlet pressure. Required inlet pressure can be easily adjusted with the pilot. It can control the drainage of booster pumps, heating and cooling systems, bypass lines, filters and other similar systems.

PRESSURE REDUCING AND SUSTAINING VALVE (PRPS)

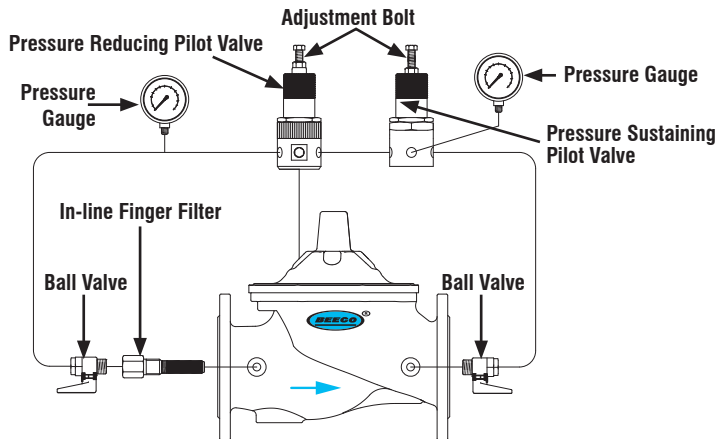

BEECO® “PRPS” model pressure reducing and sustaining valves are control valves that sustain the upstream pressure and reduce the downstream pressure to the desired value. There exist two pilot valves on the main valve. The inlet pilot valve is the pressure sustaining pilot and sustains the inlet pressure. The other pilot valve is the pressure reducing pilot valve and it reduces the downstream pressure value to the desired value and ensures that it remains constant.

FLOAT LEVEL CONTROL VALVE (FL)

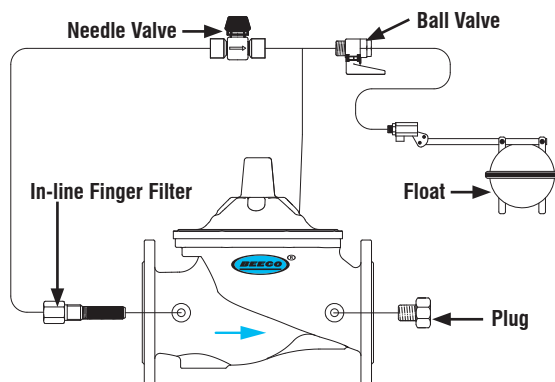

BEECO® “FL” model float level control valve is the hydraulic control valve designed to control water level in reservoirs and tanks continuously. Main valve is controlled by 2-way modulating type float pilot valve hydraulically. Main valve mounted on reservoir and tank upstream is closed as fully sealed without causing surge when water level reaches to maximum level. Valve opening/closing speed may be adjusted in set value.

CALIFORNIA PROPOSITION 65 WARNING. This product contains chemicals known to the State of California to cause cancer and birth defects or other reproductive harm.



ELECTRIC FLOAT LEVEL CONTROL VALVE (FLEL)

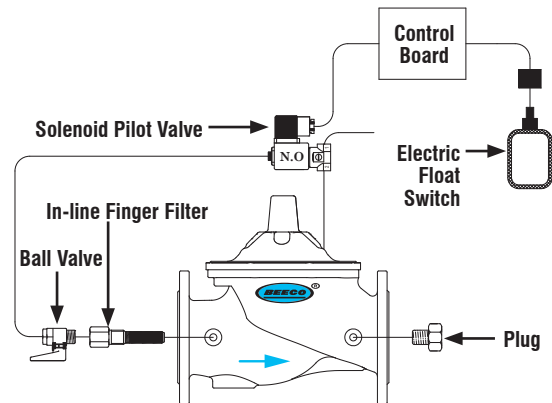

BEECO® “FLEL” model electric float level control valve is the hydraulic control valve designed to control water level continuously by means of electrical float placed in reservoirs and tanks. Electrical float sends signal to solenoid coil on main valve when water level decreases below set level. Main valve is opened and ensures that tank or reservoir will be filled permanently. When water reaches maximum level, electrical float sends signal to solenoid coil again and main valve is closed as drip-tight.



DIFFERENTIAL FLOAT LEVEL CONTROL VALVE (DIFL)

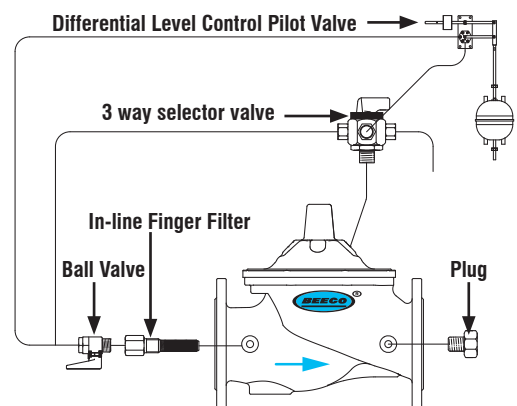

BEECO® “DIFL” model differential float level control valve is a hydraulic control valve that can control the water level in tanks or reservoirs at desired intervals. Thanks to the 4-way differential control, the main valve is closed in a fully sealed manner when the water level reaches the desired maximum level. The maximum and minimum water level in the tank or reservoir can be easily adjusted to the desired value in a wide range. Due to this feature, the pump does not switch on and off continuously during the level control of the tanks or reservoirs fed by the pump.

CALIFORNIA PROPOSITION 65 WARNING. This product contains chemicals known to the State of California to cause cancer and birth defects or other reproductive harm.

QUICK PRESSURE RELIEF VALVE (QR)

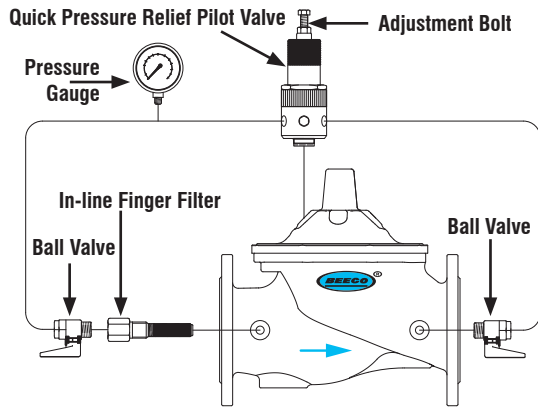

BEECO® “QR” model quick pressure relief valve is a safety valve designed to protect the network system, which automatically discharges pressure fluctuations that occur as a result of sudden changes in water speed, to the atmosphere. When the pressure of the system exceeds the set point, the valve opens itself quickly and protects the system by relieving the excess pressure. When the pressure value in the system drops to the normal level, the valve closes itself slowly and automatically without surge.

FLOW RATE CONTROL VALVE (FR)

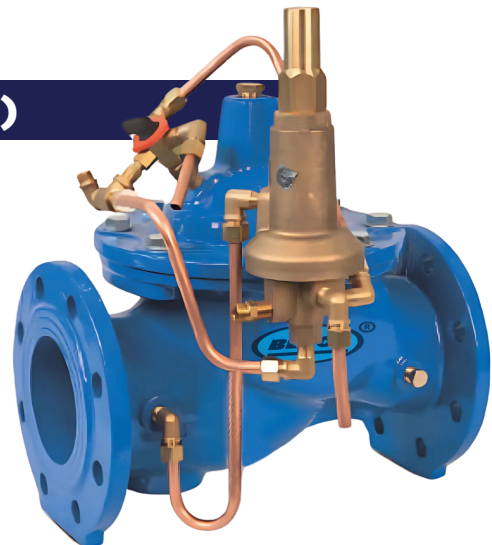
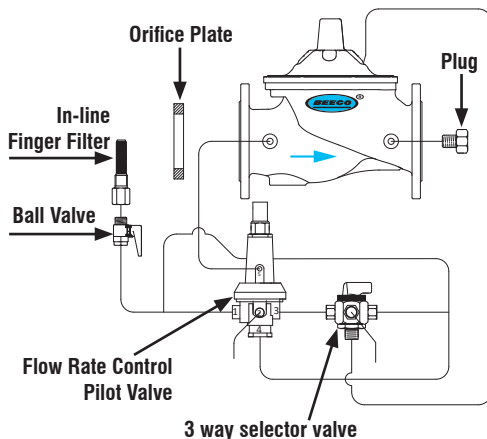

BEECO® “FR” model flow control valves are control valves designed to limit the desired flow rate. The orifice at the inlet of the main valve creates differential pressure and the 3-way differential pressure adjustment pilot senses the differential pressure and ensures the main valve to open at the adjusted flow rate. Thus, the valve automatically limits the desired flow rate and keeps it constant without being affected by the inlet pressure and flow rate changes. It prevents excessive water loss by preventing excessive flow during backwashing process in filtration systems.

CALIFORNIA PROPOSITION 65 WARNING. This product contains chemicals known to the State of California to cause cancer and birth defects or other reproductive harm.

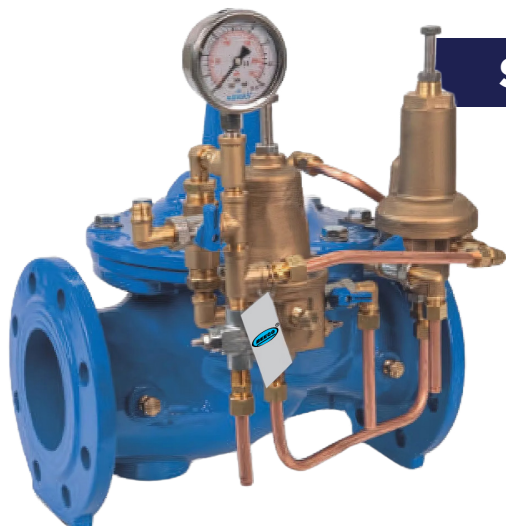

SURGE ANTICIPATING VALVE (SA)

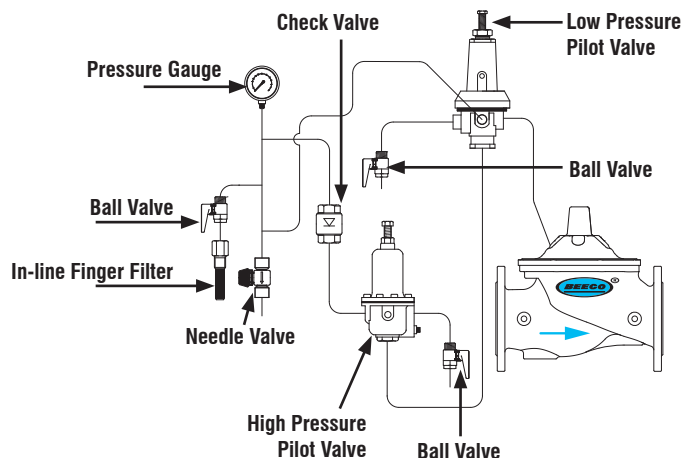

BEECO® “SA” model surge anticipating control valves are valves that absorb energy waves that occur as a result of energy cuts in pumping systems. It is a safety control valve designed to protect the network system, which automatically and quickly evacuates water hammers caused by sudden changes in water speed as a result of the pumps switching on and off in the system. The valve opens quickly by sensing the decreasing pressure wave with its pressure signal pipe and low pressure pilot. When the line pressure reaches the normal level, the valve automatically closes itself slowly and completely sealed.



PUMP (BOOSTER) CONTROL VALVE (PC)

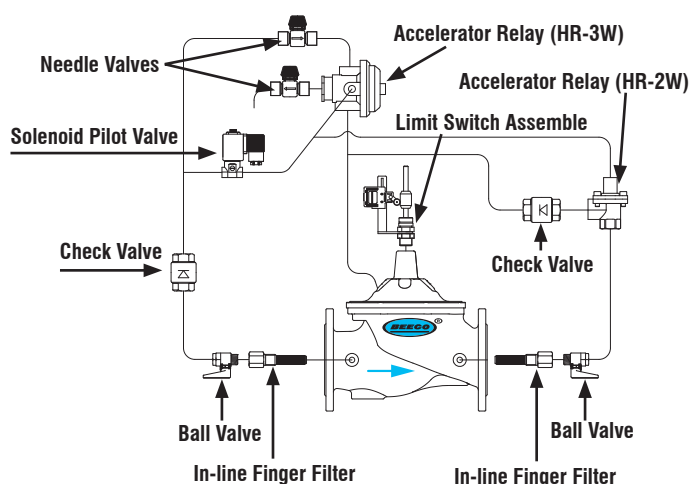

BEECO® “PC” model pump control valves are control valves designed to automatically activate and deactivate the booster type pumps used in the water network lines. As soon as the “start” button of the pump is pressed, the pump control valve is in the closed position. From pressing the start button until the pump finds its speed, the pump control valve opens itself slowly relative to the booster pump. When the “stop” button of the pump is pressed, the pump control valve is closed slowly without causing surge.

CALIFORNIA PROPOSITION 65 WARNING. This product contains chemicals known to the State of California to cause cancer and birth defects or other reproductive harm.

PUMP (DEEP WELL) CONTROL VALVE (DPC)

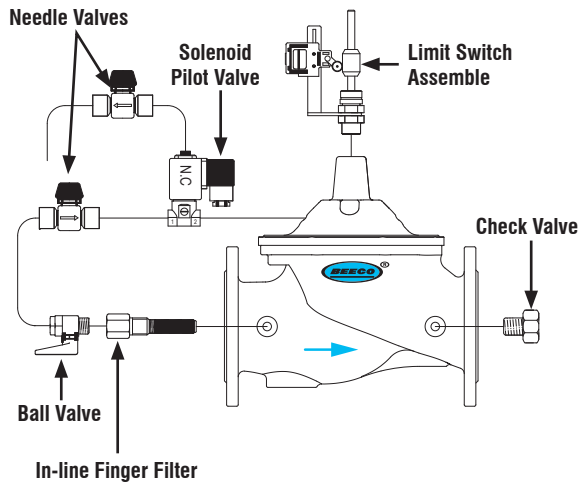

BEECO® “DPC” model deep well pump control valve is a relief valve designed to automatically activate and deactivate deep well type pumps. The valve is connected to the main line by a “TE” piece. The valve is in the open position before the pump operates. As soon as the pump starts to work, the valve closes itself slowly without causing surge and gradually increases the system pressure. Before the pump stops, the valve opens slowly and gradually reduces the system pressure.

EXCESSIVE FLOW SHUT-OFF VALVE (FE)

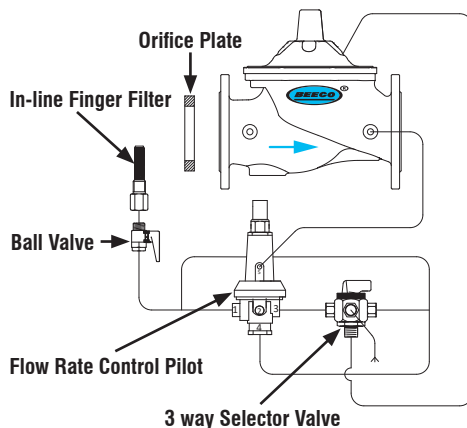

BEECO® “FE” model excessive flow shut-off control valve is hydraulic control valve that operate with line pressure and close when flow is above the set flow rate. The valve opens fully while passing water rate is below the set flow rate. With the help of the 3-way differential pilot valve and orifice, valve closes itself in a completely sealed way when flow rate exceeds the set value. Thanks to this feature, it closes itself in case of damage such as pipe bursting and prevents water wastage.

CALIFORNIA PROPOSITION 65 WARNING. This product contains chemicals known to the State of California to cause cancer and birth defects or other reproductive harm.



ELECTRONICALLY CONTROLLED VALVE (EC)

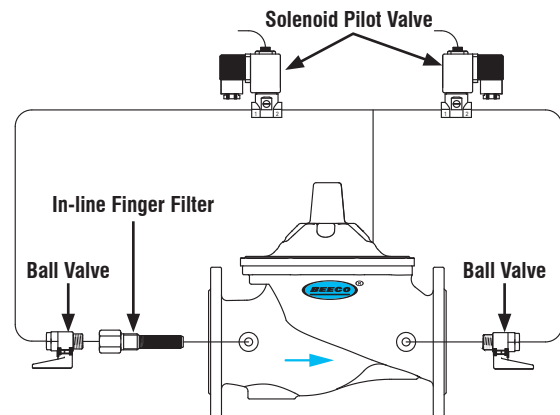

BEECO® “EC” model electronically controlled valves can provide local or remote control in time related applications, and automatic control systems. The valve is controlled by two solenoid valves and the solenoids controlled by PLC controller. It has a simple and reliable design that works with low energy.



ALTITUDE CONTROL VALVE (ALT)

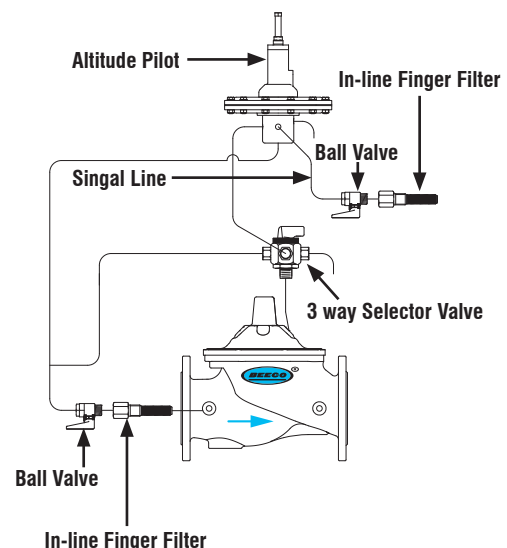

BEECO® “ALT” model altitude control valves are pilot-controlled automatic level control valves with high sensitivity, which are active with the water level in water towers. The high-precision pilot valve, which senses the water level in the water towers, opens or closes the main valve. As the pilot valve located outside the water tower, no pilot float is required.

CALIFORNIA PROPOSITION 65 WARNING. This product contains chemicals known to the State of California to cause cancer and birth defects or other reproductive harm.

BI-LEVEL ALTITUDE CONTROL VALVE (ALT-B)

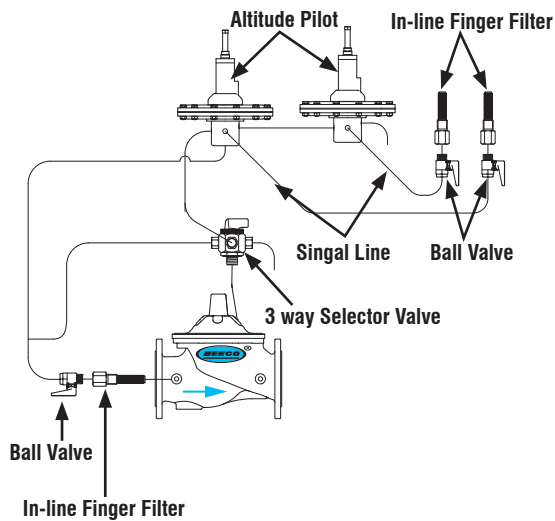

BEECO® “ALT-B” model bi-level altitude control valves are two pilot-controlled automatic level control valves with high sensitivity, which are active with the water level in water towers. The high-precision pilot valve, which senses the water level in the water towers, opens or closes the main valve. As the pilot valve located outside the water tower, no pilot float is required. One of the pilot valves control the minimum water level and the other controls the maximum water level.

FLOW RATE CONTROL AND PRESSURE REDUCING VALVE (FRPR)

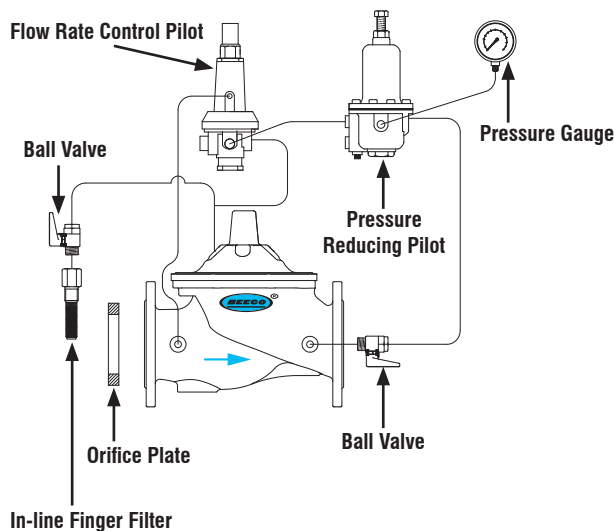

BEECO® “FRPR” model flow rate control and pressure reducing valves provide two functions independently. There is a 3-way differential pilot on the valve that works with line pressure without requiring any other energy. The pressure reducing pilot valve controls the outlet pressure of the valve. Flow control is provided with this pilot. Flow rate control and pressure reducing valves offer two separate valve functions in a single valve.

CALIFORNIA PROPOSITION 65 WARNING. This product contains chemicals known to the State of California to cause cancer and birth defects or other reproductive harm.



Distributed by: **MIFAB**

Terms & Conditions

WHOLESALE DISCOUNT: Contact BEECO® or your local representative for your applicable discount structure.

FREIGHT ALLOWANCE: Ex Works, BEECO®'s Chicago, Illinois Factory or Manufacturer Representative's warehouse with full motor freight allowed on shipments of \$3,500 Net or more, within the continental U.S.A. or Canada, except Alaska, Hawaii and Puerto Rico. BEECO® reserves the right to choose the carrier and route of shipment. Alaska: Ex Works, Seattle, WA. Hawaii: Freight allowed on shipments of \$3,500 or more only when shipped from West Coast, U.S. Puerto Rico: Ex Works, Miami, Florida. There is no allowance for United Parcel Service, Federal Express or Shipment by air service. Full motor freight is allowed on shipments of \$3,500 Net or more, within the continental U.S.A. and Canada for any combination of BEECO®, Counterline, No Hub Coupling, Trench Drain, Access Door and Trap Seal Primer products. Shipping dates are estimates and time of delivery is not the essence of the sale of the contract. Therefore, under no circumstances will BEECO® have any responsibility on account of any delays in manufacture, transportation, or otherwise. Additional freight services such as construction site delivery, lift gate delivery service, re-consigned freight or notification charges, are not included in full freight allowance terms, and will result in additional freight charges.

QUOTATION TERMS: List Price and discount protected for 30 days from date issued by BEECO®. Orders received within this period must be released for shipment within 30 days from date of purchase order, otherwise, prices will be those that are in effect at the time of shipment.

PAYMENT TERMS: Terms of payment are Net 30 days from the date of the invoice. All pricing in United States currency unless sold in Canada in which case Canadian dollars is the currency used. The Buyer shall pay all sales, consumers, and / or any other applicable taxes. Past due accounts will be subject to a 2% per month service charge from the date of the invoice. If any proceedings be instructed by or against Buyer under any bankruptcy or insolvency law, or if Buyer shall fail to make timely payment on this or any other order, or if, in MIFAB's judgment, Buyer's financial situation justifies such action, BEECO® may, at its election, require payment in advance or cancel the order as to any unshipped item and require payment of its reasonable cancellation charges. If Buyer delays completion of manufacture, BEECO® may elect to require payment according to percentage of completion. Equipment held for Buyer shall be at Buyer's risk and expense. In all cases, regardless of partial payment, title to the Products shall remain with BEECO® until payment for the Products (including any notes given therefore) has been made in full. Should legal action be necessary to enforce payment of an unpaid invoice, the Buyer will assume full responsibility for any court costs and reasonable attorney fees. All orders subject to credit check and approval prior to shipment. Confirmed irrevocable letter of credit or cash in advance of shipment is required for accounts without an established line of credit. Minimum invoice amount is \$100. BEECO® reserves the right to apply a minimum order charge to equal \$100. BEECO®'s Accounting Department must be notified of potential pricing errors within 30 days of the invoice date. Any terms and conditions stated on Buyer's orders which are inconsistent with MIFAB's quotation and Terms and Warranties shall be of no effect.

RETURNED GOODS RESTOCKING CHARGE: Standard product may be returned within a one year period only with written permission from BEECO®. All products in catalog are not considered Standard. Standard product to be determined by BEECO®. Returned goods are subject to a 25% restocking charge, plus cost of reconditioning, if necessary, to make material saleable. Material must be returned to BEECO® freight prepaid only after written permission from BEECO® to accept the returned material. Buyer must provide copy of the original invoice on which the material was charged. The original outgoing freight cost to ship the order will be deducted from the credit. Credit allowance will be in the form of merchandise credit only-not cash credit which must be used within 12 months of the date of issue. The value of a return must total \$100 to qualify for credit allowance. Products designated non stock and / or that have been specially made (require a sign off drawing by BEECO®) are not subject to return or cancellation.

LIMITED WARRANTY: BEECO® warrants each product against defects in material and workmanship for a period of one year from the date of original shipment. In the event of such defects within the warranty period, BEECO® will, at its option, replace or recondition the product without charge. This shall constitute the exclusive remedy for breach of warranty, and BEECO® shall not be responsible for any incidental or consequential damages, including, without limitation, damages or other costs resulting from labor charges, delays, vandalism, negligence, fouling caused by foreign material, damage from adverse water conditions, chemicals, or any other circumstances over which BEECO® has no control. This warranty shall be invalidated by any abuse, misuse, misapplication or improper installation of the product. For inoperative products beyond the warranty period, we assume no liability for replacement of valves due to service conditions beyond our control. Consult local codes and specifications and have a qualified licensed professional install all BEECO® devices.

BEECO® MAKES NO OTHER WARRANTIES EXPRESSED OR IMPLIED AS PROVIDED IN THIS LIMITED WARRANTY.

ILLUSTRATIONS OR TYPICAL INSTALLATIONS: The typical installations for various products in each product section are intended to illustrate the products and their options. Under no circumstances are they to be construed as recommended installation procedures. Consult local codes and project specifications for proper installation instructions.

ALL SALES SUBJECT TO BEECO®'S TERMS AND WARRANTIES.

NOTE: Prices and terms are subject to change without notice and supersede all previous quotations. The right is reserved to change or modify product design or construction without prior notice and without incurring any obligation to make similar changes and modifications to product previously or subsequently sold. Contact BEECO® for any clarification.

CONTENTS © BEECO® INC. Copyright 2025

CALIFORNIA PROPOSITION 65 WARNING. This product contains chemicals known to the State of California to cause cancer and birth defects or other reproductive harm.

MIFAB CATALOGS



MPB-2025-USA
SPECIFICATION DRAINAGE
PRODUCTS
(LIT-067)



CLPB-2025
LIGHT COMMERCIAL
PRODUCTS
(LIT-048)



AD-2024-USA
ACCESS DOORS
(LIT-043)



BEECO-2025
BACKFLOW PREVENTERS,
PRESSURE REDUCING VALVES,
AUTOMATIC CONTROL VALVES,
AND ACCESSORIES
(LIT-071)



NH-2022-06
NO HUB COUPLINGS
(LIT-044)



TDPC-2025
POLYMER CONCRETE
TRENCH DRAINS
(LIT-076)



TD-2025
GRP & STEEL
TRENCH DRAINS
(LIT-046)



TDSD-2025
SHOWER DRAINS
(LIT-077)



TDSS-2025
STAINLESS STEEL
TRENCH DRAINS
(LIT-072)



ROOFGUARD-2020
ROOFGUARD ROOF
DOMES
(LIT-058)



C-PORT-2023
ROOFTOP RUBBER
PIPE SUPPORTS
(LIT-047)



DB-2024
DIALYSIS BOXES
(LIT-070)



HYDROMAX-2020
SIPHONIC DRAINAGE
SYSTEMS
(LIT-082)



INT-2025
INTERCEPTORS & ACID
NEUTRALIZATION TANKS
(LIT-095)



TSP-2024
TRAP SEAL
PRIMERS
(LIT-062)



CALIFORNIA PROPOSITION 65 WARNING. This product contains chemicals known to the State of California to cause cancer and birth defects or other reproductive harm.



A DIVISION OF:  **MIFAB**®



Visit www.beecobackflow.com for the most recent product information.

FLOW CONTROL SYSTEMS