

Each extension provides up to 9" of height extension. If more than 9" of extension is required, stack multiple extension assemblies.

Includes:
(2) Extension components
(10) Zip ties

Equipment Required:
Silicone sealant
Saw

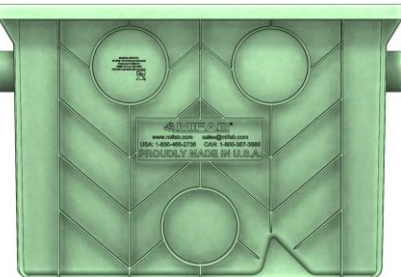
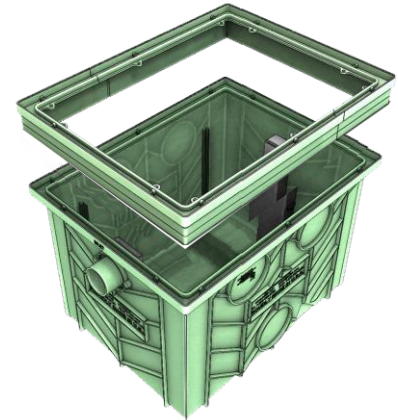

STEP 1 Measure the height from the top of the interceptor to the desired ground level

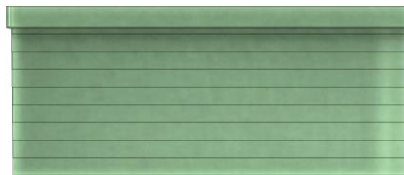

STEP 2 Cut off the bottom of each extension component to the desired height. (Note: if possible leave banding holding extension together intact.)

STEP 3 Remove the lid and place the extension onto the Lil Max Interceptor

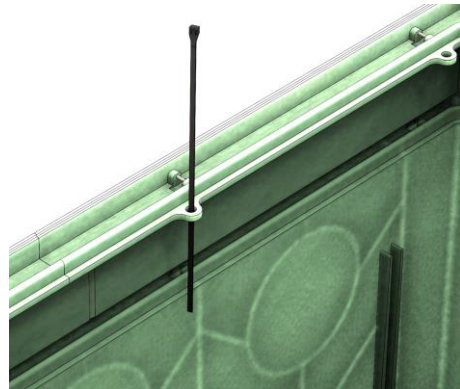

STEP 4 Place the zip ties through the holes in the extension. There are 10 zip ties, one for each hole.

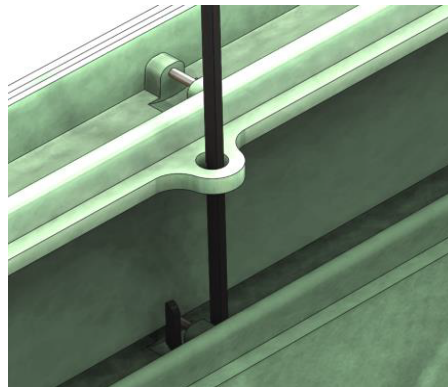

STEP 5 Tighten the zip ties around the pins of the interceptor or through the next hole if using more than one extension.



STEP 6 Silicone caulk gap between outside of extension and rim of Lil Max. Remove extension banding and silicone caulk two extension seams.

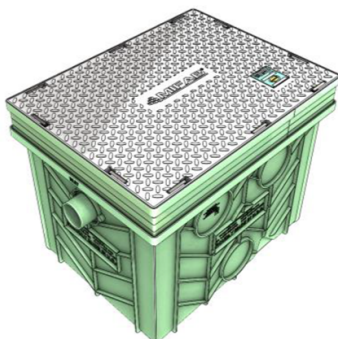

STEP 7 Place the interceptor lid onto the extension.

View Installation video at:
www.youtube.com.....

