

## T5000-300 3" Wide, 5 7/8" Deep Aluminum Channel

### Specification:

MIFAB® Series T5000-300, 3" wide, 5 7/8" deep, 40" long, non sloped channels. Channel is manufactured from 14 gauge aluminum. Channels have flanged ends to connect to each other with a neoprene rubber gasket. End and bottom outlets are available in 2" no hub outlet connections and are fabricated as part of the trench drain system. Available with anchor flanges and membrane clamps as required.

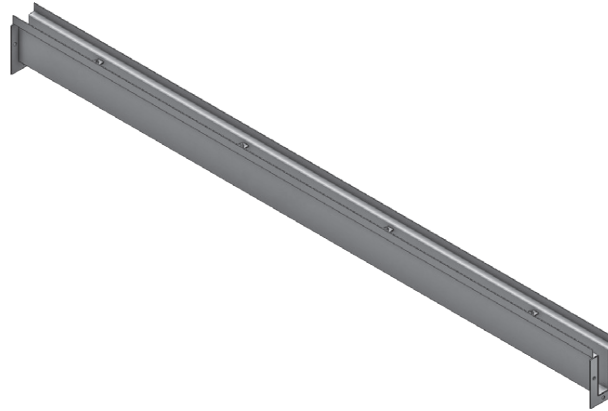

| CHANNEL MODEL NUMBER | DESCRIPTION  |
|----------------------|--|
| T5000-300            | 3" wide, 5 7/8" deep, 14 gauge aluminum channel only |

| Grates (all 40" long. One grate required per body section) |   |
|--|---|
| Order Guide Suffix   | Description   |
| PGA-AL   | Aluminum decorative slotted grate - Class A, 40" long   |
| PGA-AW   | Aluminum wire grate - Class A, 40" long   |
| PGA-SS   | Stainless Steel, Decorative grate - Class A, 40" long   |
| PGB-WW   | Stainless Steel, Wedgewire grate - Class A, 40" long  |
| End Caps / Outlets / Accessories                           |   |
| Order Guide Suffix   | Description   |
| -PEC   | Closed end cap  |
| -PEO2  | 2" no hub end outlet  |
| -PBO2  | 2" no hub bottom outlet   |
| MI-FLEX-200  | 2" Flexible rubber coupling to connect 2" No Hub vertical and horizontal channel outlets to drainage pipe |

| Accessories and 45° and 90° Degree Fabrications |   |
|---|---|
| Order Guide Suffix                              | Description   |
| Standard  | 5/16-18 x 2" Zinc Coated Bolts (2 per package) - for grate lockdown     |
| -SSB  | 5/16-18 x 2" Stainless Steel Bolts (2 per package) - for grate lockdown |
| -PB-45-AL                                       | 45° Degree Channel Section with Aluminum decorative slotted grate       |
| -PB-90-AL                                       | 90° Degree Channel Section with Aluminum decorative slotted grate       |
| -PB-45-AW                                       | 45° Degree Channel Section with Aluminum wire grate                     |
| -PB-90-AW                                       | 90° Degree Channel Section with Aluminum wire grate                     |
| -PB-45-SS                                       | 45° Degree Channel Section with Stainless Steel Decorative grate        |
| -PB-90-SS                                       | 90° Degree Channel Section with Stainless Steel Decorative grate        |
| -PB-45-WW                                       | 45° Degree Channel Section with Stainless Steel Wedgewire grate         |
| -PB-90-WW                                       | 90° Degree Channel Section with Stainless Steel Wedgewire grate         |
| -TEE  | TEE Fabrication   |
| -CF   | Cross Fabrication   |
| -C  | Membrane clamps (2 - one for each side of the body) with hardware       |

**NOTES: SPECIFYING ENGINEER IS RESPONSIBLE FOR CONCRETE ENCASEMENT AND REINFORCING DETAIL**

**Revision Date: 08/11/2021**

CALIFORNIA PROPOSITION 65 WARNING. This product contains chemicals known to the State of California to cause cancer and birth defects or other reproductive harm.

MIFAB reserves the right to make changes in material and design without formal notice and obligation. USA: 1-800-465-2736 [www.mifab.com](http://www.mifab.com) CAN: 1-800-387-3880