

Location: _____



T1460-CI

**CHANNEL INSERT FOR ALL
T1460N GRP CHANNELS**

Specification: MIFAB® T1460-CI plastic channel insert to fill the expansion gap between the T1460N channels.

Function: Used as an insert to fill the expansion gap (if required) between the T1460N channels.

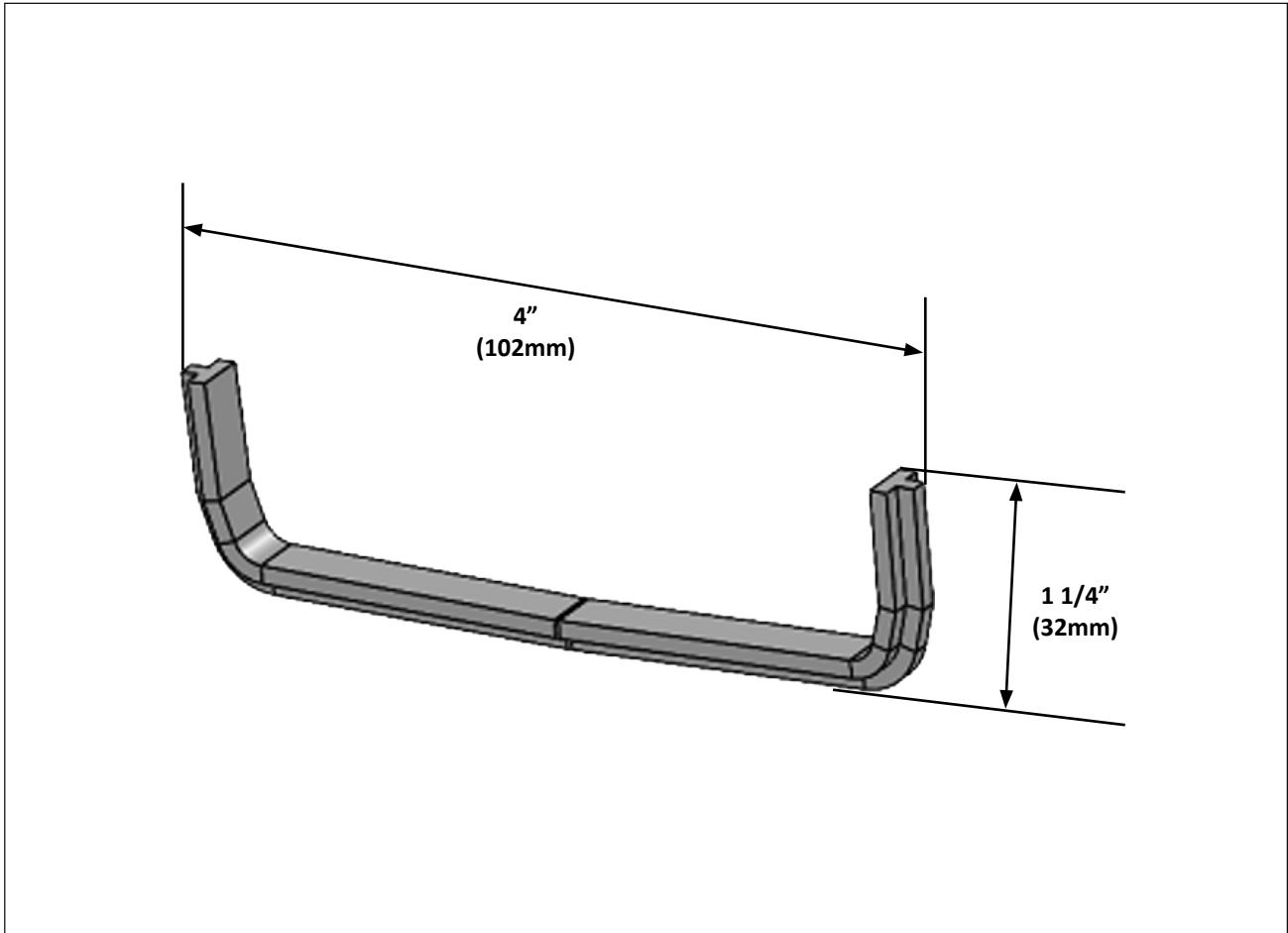

CALIFORNIA PROPOSITION 65 WARNING. This product contains chemicals known to the State of California to cause cancer and birth defects or other reproductive harm.

Job Name: _____ Page No: _____

Section No: _____ Contractor: _____

Schedule No: _____ Purchase Order No: _____

MIFAB reserves the right to make changes in material and design without formal notice and obligation. USA: 1-800-465-2736 www.mifab.com CAN: 1-800-387-3880

2023-04-15