

Location: _____



SL ACCESS DOOR

SERIES SL SEAMLESS ACCESS PANELS

Specification: Seamless™ Access Panels by MIFAB® are manufactured from GFRGIGFRC & 70% post-consumer recycled glass, for a unique GREEN design-matrix designed to blend seamlessly into your walls and ceilings. They consist of a surround frame and either a drop-in door or hinged door. Available in twenty standard residential or commercial sizes, MIFAB® panels are perfect for jobs where access is required at regular intervals.

Function: Lightweight and easily textured, the panels can be used in both new and retrofit construction across unlimited applications. Their smart design to help contractors work smarter faster and better, the Seamless™ panels feature a tapered edge for tape joints and won't shrink, crack or sag. Seamless™ Access Panels provide an aesthetically pleasing solution for a more attractive interior.

PRODUCT FEATURES

- Tapered edge for tape joint
- Lightweight
- No shrinking, cracking, sagging or rusting
- Concealed hinge
- Moisture resistant
- Easily textured
- Single trade installation
- Blends seamlessly into surrounding drywall
- Reduce labor costs
- Zero mold & fungus growth

- Custom sizes available
- Round pop-out panels available
- Neoprene gasket available upon request



Door-in-Door



Frame taped onto drywall

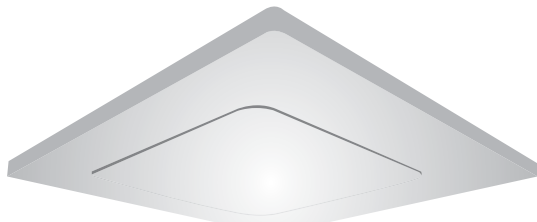

SL0909-RC illustrated

Color finish: Unpainted natural grey gypsum

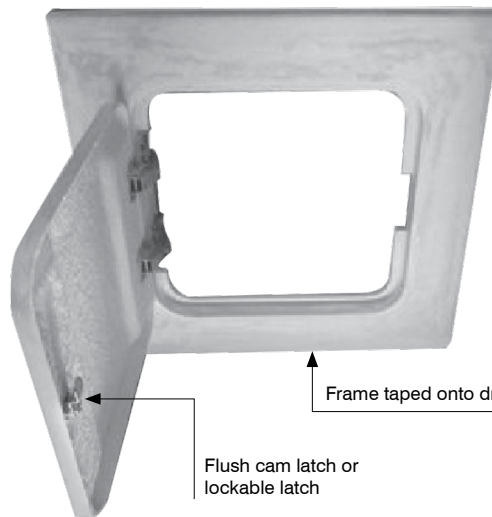

Frame taped onto drywall

Flush cam latch or lockable latch

SL0909-RC illustrated

CALIFORNIA PROPOSITION 65 WARNING. This product contains chemicals known to the State of California to cause cancer and birth defects or other reproductive harm.

Job Name: _____

Page No: _____

Section No: _____

Contractor: _____

Schedule No: _____

Purchase Order No: _____

Location: _____



SL ACCESS DOOR

SERIES SL SEAMLESS ACCESS PANELS

GENERAL DRAWING POP-OUT OR HINGED

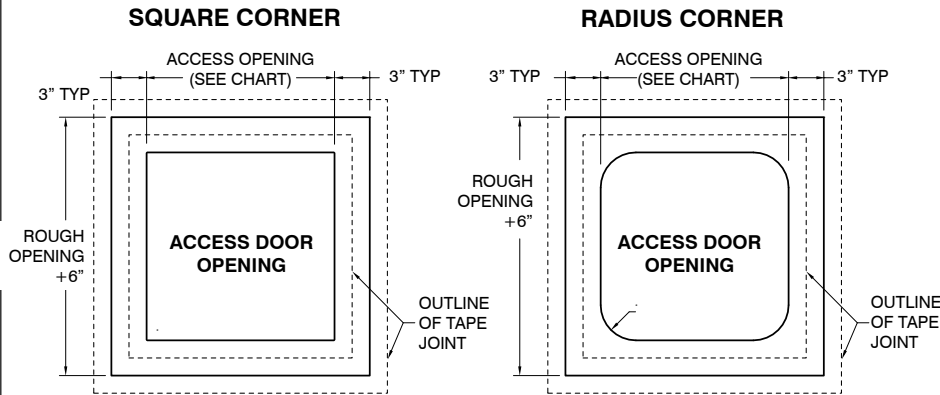

POP-OUT SPECIFICATION

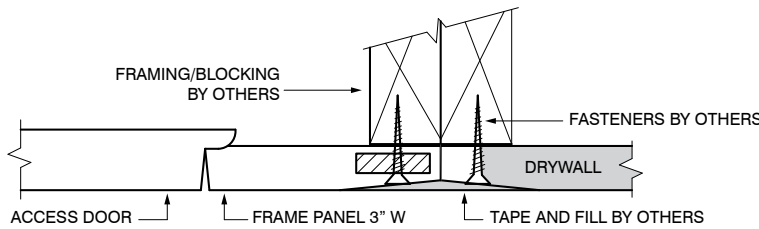

HINGED SPECIFICATION

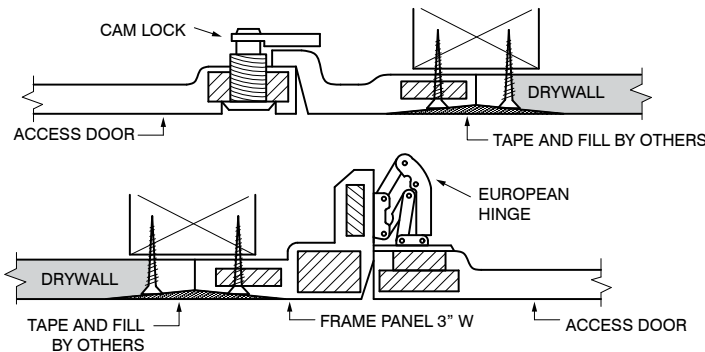

HOW TO INSTALL ACCESS PANELS



1. Frame the opening.



2. Mount Seamless™ surround with drywall screws.



3. Mounted frame.



4. Install drywall and place access panel in opening.



5. Tape and apply drywall compound.



6. Apply desired finish.

SEAMLESS PANELS TECHNICAL DATA

Shell Thickness	1/8" to 3/16"
Fastener Test Pull Out (wood stud)	525 lb avg.
Fastener Test Pull Out (metal stud)	215 lb avg.
Fastener Push Through Test	350 lb avg.
Fuel Contribution (ASTM E84-80)	0
Flame Spread (ASTM E84-80)	0
Smoke Index (ASTM E84-80)	0
Combustion (ASTM E84-80)	Non-combustible
Class A Non-Rated	-

Designed for both wall and ceiling applications, the hinged Seamless™ Panel by MIFAB® can be used where a locked door is needed but style must still be maintained. The hinged panel is great for use in ceiling applications where there is no space to push a door up, and in wall applications when access to plumbing and electrical is needed.

- The **Seamless™** Hinged Access Panel and Pop-out Panel consists of a frame door with concealed hinges and a cam or key lock.
- Round Pop-out Panel available in five sizes.
- **Neoprene Gasket** available for all panels upon request.
- These panels require extra reinforcement and a crate or pallet to ship.
- Ships directly from the manufacturing plant in Concord, ON Canada.

CALIFORNIA PROPOSITION 65 WARNING. This product contains chemicals known to the State of California to cause cancer and birth defects or other reproductive harm.

Job Name: _____ Page No: _____
 Section No: _____ Contractor: _____
 Schedule No: _____ Purchase Order No: _____

Location: _____



SL ACCESS DOOR

SERIES SL SEAMLESS ACCESS PANELS

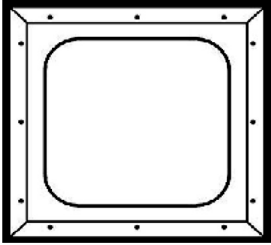

POP-OUT - RADIUS CORNER			
Model Number	Pop-Out Size	Rough Opening	Weight per/panel
SL0909-RC	9" x 9"	15" x 15"	6 lbs
SL1212-RC	12" x 12"	18" x 18"	8 lbs
SL1616-RC	16" x 16"	22" x 22"	10 lbs
SL1818-RC	18" x 18"	24" x 24"	11 lbs
SL2424-RC	24" x 24"	30" x 30"	16 lbs

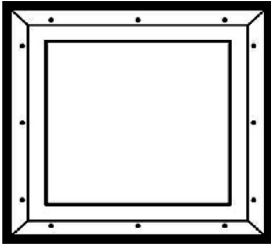

POP-OUT - SQUARE CORNER			
Model Number	Pop-Out Size	Rough Opening	Weight per/panel
SL0909-SC	9" x 9"	15" x 15"	6 lbs
SL1212-SC	12" x 12"	18" x 18"	8 lbs
SL1616-SC	16" x 16"	22" x 22"	10 lbs
SL1818-SC	18" x 18"	24" x 24"	11 lbs
SL2424-SC	24" x 24"	30" x 30"	16 lbs

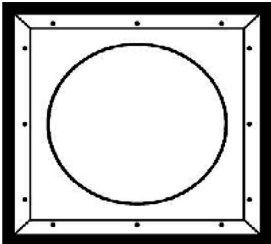

POP-OUT - ROUND			
Model Number	Pop-Out Size	Rough Opening	Weight per/panel
SL09-RD	9" diameter	15" x 15"	6 lbs
SL12-RD	12" diameter	18" x 18"	9 lbs
SL16-RD	16" diameter	22" x 22"	10 lbs
SL18-RD	18" diameter	24" x 24"	11 lbs
SL24-RD	24" diameter	30" x 30"	16 lbs

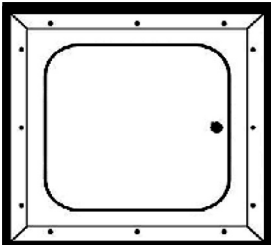

HINGED RADIUS CORNER- Comes with Cam-Latch			
Model Number	Pop-Out Size	Rough Opening	Weight per/panel
SL0909-HG-RC	9" x 9"	15" x 15"	12 lbs
SL1212-HG-RC	12" x 12"	18" x 18"	15 lbs
SL1616-HG-RC	16" x 16"	22" x 22"	17 lbs
SL1818-HG-RC	18" x 18"	24" x 24"	18 lbs
SL2424-HG-RC	24" x 24"	30" x 30"	22 lbs

Specify Cam-Latch: Slotted S1, Keyed Alike K1

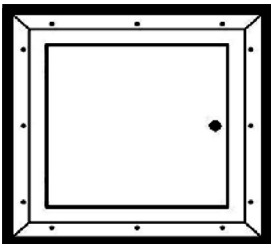

HINGED SQUARE CORNER- Comes with Cam-Latch			
Model Number	Pop-Out Size	Rough Opening	Weight per/panel
SL0909-HG-SQ	9" x 9"	15" x 15"	12 lbs
SL1212-HG-SQ	12" x 12"	18" x 18"	15 lbs
SL1616-HG-SQ	16" x 16"	22" x 22"	17 lbs
SL1818-HG-SQ	18" x 18"	24" x 24"	18 lbs
SL2424-HG-SQ	24" x 24"	30" x 30"	22 lbs

Specify Cam-Latch: Slotted S1, Keyed Alike K1

Packaged ONE per/carton OEM KRAFT Box.
 Neoprene Gasket available upon request on all model types addition charge.
 Freight is extra on all seamless access door orders.

CALIFORNIA PROPOSITION 65 WARNING. This product contains chemicals known to the State of California to cause cancer and birth defects or other reproductive harm.

Job Name: _____ Page No: _____
 Section No: _____ Contractor: _____
 Schedule No: _____ Purchase Order No: _____